



XY7000 Series



FEATURES

1. Low power consumption, energy saving and environmental protection,
2. High working frequency, high working pressure, widely used
3. Smaller size, saving space
4. Multiple connection method
5. Sliding column structure have good sealing and sensitive response
6. The inner hole is processed by special technology, with low friction resistance, low starting air pressure and long service life
7. The valve group can be integrated with the base, which save installation space

SPECIFICATION

Model No.	XY7120A	XY7220A	XY7320A	XY7420A	XY7520A
	XY7140A	XY7240A	XY7340A	XY7440A	XY7540A
Working Medium	Compressed Air				
Valve Type	5/2 Single Coil	5/2 Double Coil	5/3 center close type	5/3 center exhaust type	5/3 center pressure type
Port Size	Inlet = Outlet = EExhaust= G1/8 (XY7_20) Nanur Type (XY7_40)				
Working Pressure	0.15-0.7		0.2-0.7		
Ensured Pressure Resistance	1.0				
Operating Temperature	-5℃ ~ 50℃				
Max. Operating Frequency	8		3		
Connection Method	Vertical / Parallel / Vertical Parallel				
Voltage Range	Rated Voltage ± 10%				
Protection Class	IP65				
Main Material	Aluminum				

ORDERING CODE

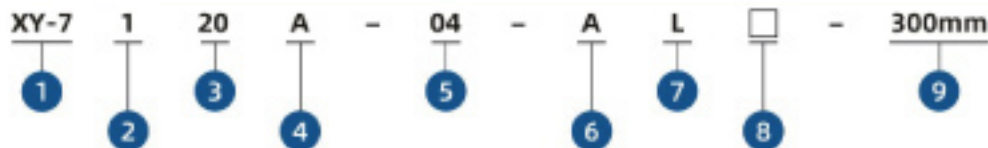

1. Model Series
XY-7
2. Valve Type
1: 5/2 Single Coil
2: 5/2 Double Coil
3: 5/3 double coil center close type
4: 5/3 double coil center exhaust type
5: 5/3 double coil center pressure type
3. Connection Method
20:M5
40:Namur Type
4. Manual Operation
A: Press the lock button then turn
5. Connection Port
04:G1/4 05:PT1/4
06:NPT1/4
6. Voltage Type
A: AC220V B: DC24V
C: AC110V D: DC12V
E: AC24V
7. Wire Lead Type
L: Vertical M: Parallel
N: Vertical Parallel
P: Pin Type
8. Indicator light, surge, voltage protection circuit
Blank: With indicator light,
no surge and voltage protection
R: With indicator light,
surge and voltage protection
Z: No indicator light,
surge and voltage protection
Z: No indicator light,
with surge and voltage protection
* No indicator light for pin type
9. Wire Length
300mm 600mm Customized

INSTALL AND OPERATION

1. When taking the solenoid valve, do not drop or drop it to avoid damage to the solenoid valve.
2. Due the pilot valve is a precision component, please do not crush the pilot valve to avoid damage.
3. Do not disassemble the solenoid valve when using, if the pilot valve screw (M1.6×14) is accidentally loose, please tighten it with a torque range of 0.1-0.12N.m.

FLOW CHARACTERISTICS

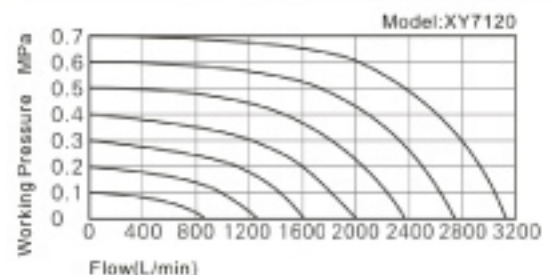



XY7120 Dimensional Graphy

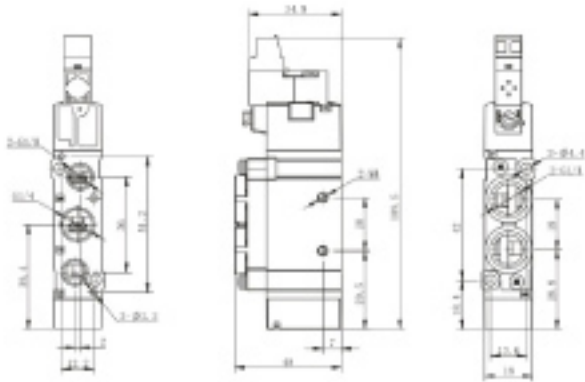

XY7140 Dimensional Graphy

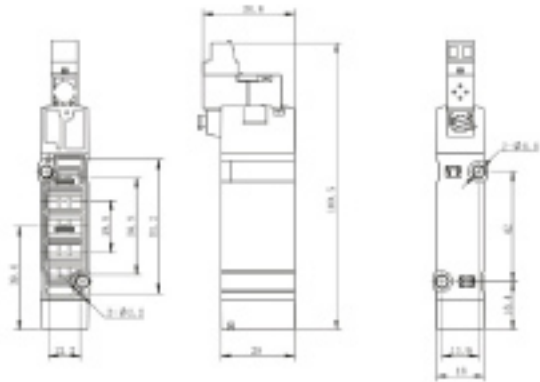

XY7220 Dimensional Graphy

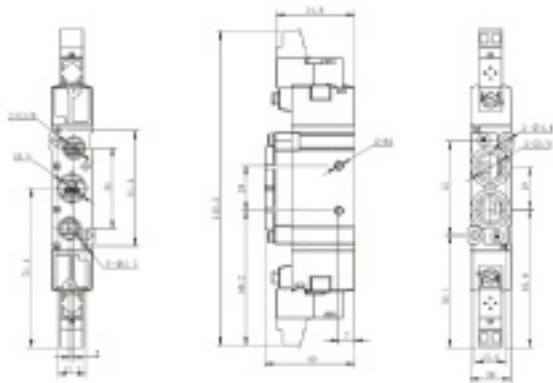

XY7240 Dimensional Graphy

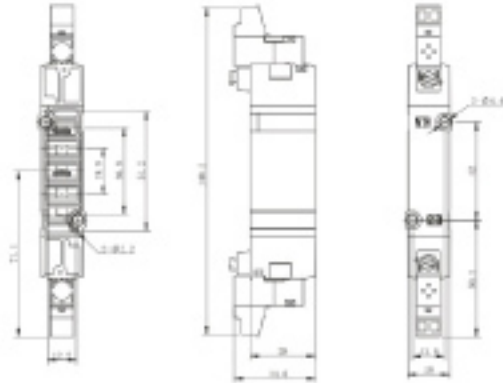

XY7320 Dimensional Graphy

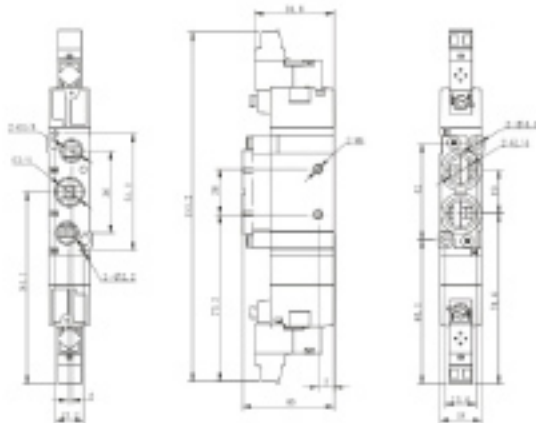

XY7340 Dimensional Graphy

